

HYBRID STEPPING MOTOR SPECIFICATION

DIMENSIONS unit=mm

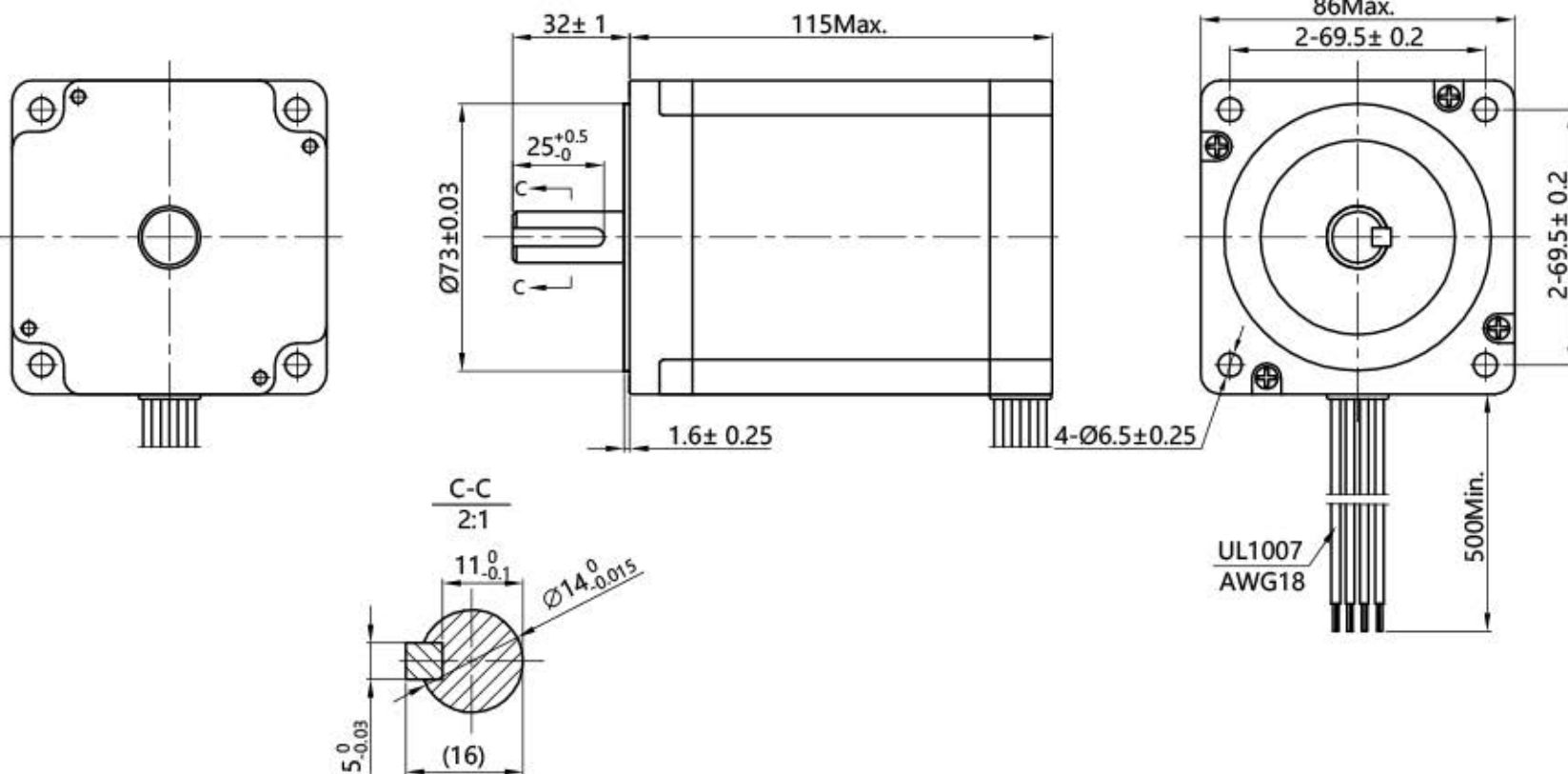

Wiring Diagram

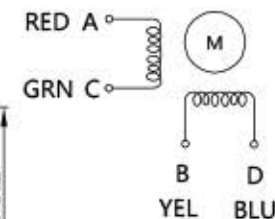

Exciting Sequence vs. Direction of Rotation

STEP	A	B	C	D	Direction
1	+	+	-	-	↑ CCW ↓ CW
2	-	+	+	-	
3	-	-	+	+	
4	+	-	-	+	

Clockwise view from mounting side

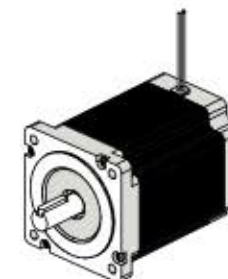

1. Number of Phase	2			
2. Step Angle	1.8° deg.			
3. Rated Voltage	3.6 V			
4. Rated Current/Phase	6 A (Peak Value)			
5. Phase Resistance	0.6 Ω ± 0.1(20°C)			
6. Phase Inductance	6.5 mH ± 20%(1kHz 1V RMS)			
7. Holding Torque	8.7 N.m			
8. Insulation Class	B (130°) ; 80K Max.			
9. Weight	3.8 kg			
Specifications		Comment		

REV.	REVISION RECORD	DATE
	DESIGN	
	STANDARD	
	TECHNOLOGY	
	CHECK	
	APPROVE	

常州倍士福机电有限公司
www.besfoc.cn

Specification

TITLE	STEPPING MOTOR				
DWG.NO.	BF86HS115-6004-05				
MATERIAL	ECN SIGN	*	SIZE	A4	
REV.	A	SCALE	1:2	SHEET	1 of 1