

Dimension:
Unit=mm

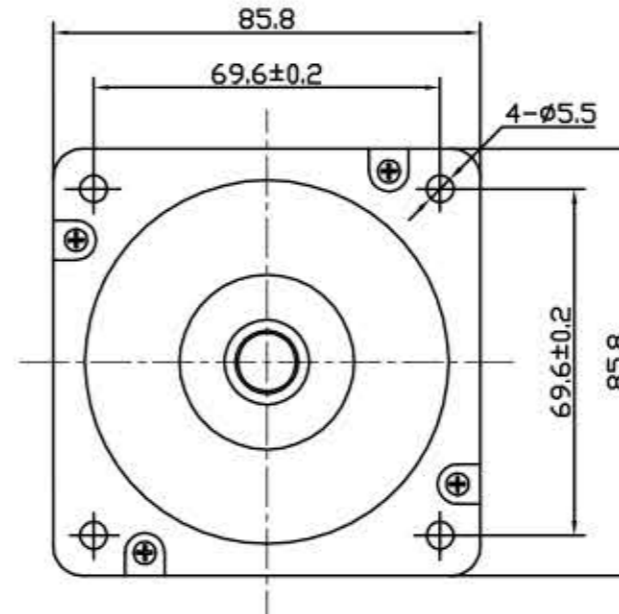
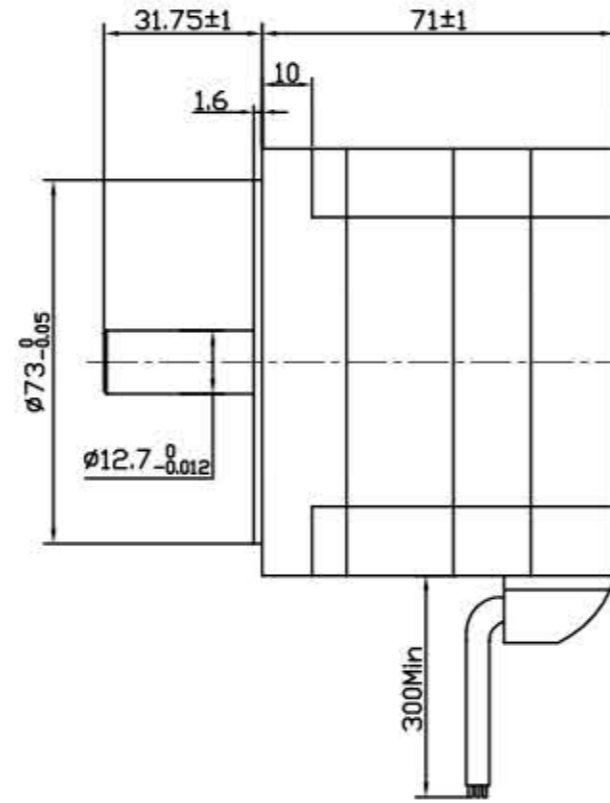

ROTATION: CW SEE FROM LEAD END

MANUFACTUER MODEL	JK86BLS58-X002
NUMBER OF POLES	8
PHASE TO PHASERESISTANCE	1.1 OHMS
NOMINAL VOLTAGE	48 VDC
NO LOAD SPEED	3700±10% RPM
NO LOAD CURRENT	0.8 Amps Max.
RATED TORQUE	0.35 N-m
RATED SPEED	3000±10% RPM
OUTPUT POWER	110 W
BACK EMF CONSTANT	13 V/kRPM
TORQUE CONSTANT	0.124 N-m/A
INSULATION CLASS	B

ELECTRICAL CONNECTION TABLE

+5V	RED	红	UL1007 26 AWG
HALL U	YEL	黄	
HALL V	GRE	绿	
HALL W	BLU	蓝	UL1015 18 AWG
GND	GND	黑	
PHASE U	YEL	黄	
PHASE V	GRE	绿	
PHASE W	BLU	蓝	

Connection diagram:

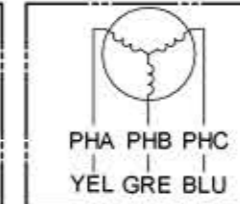
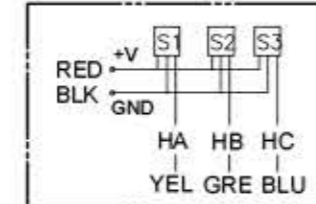

Hall sens or cable
Note: hall sens or power supply
voltage +5 to +20VDC

Wiring cable

REV.					
DESIGN					
CHECK					
PROC.					

Title:		常州倍士福机电有限公司	
Specification		BF86BLS58-X002	
CLS.MAK	WEIGHT	SCALE	www.besfoc.cn
PAGE: 1/1			