

HYBRID STEPPING MOTOR SPECIFICATION

DIMENSIONS unit=mm

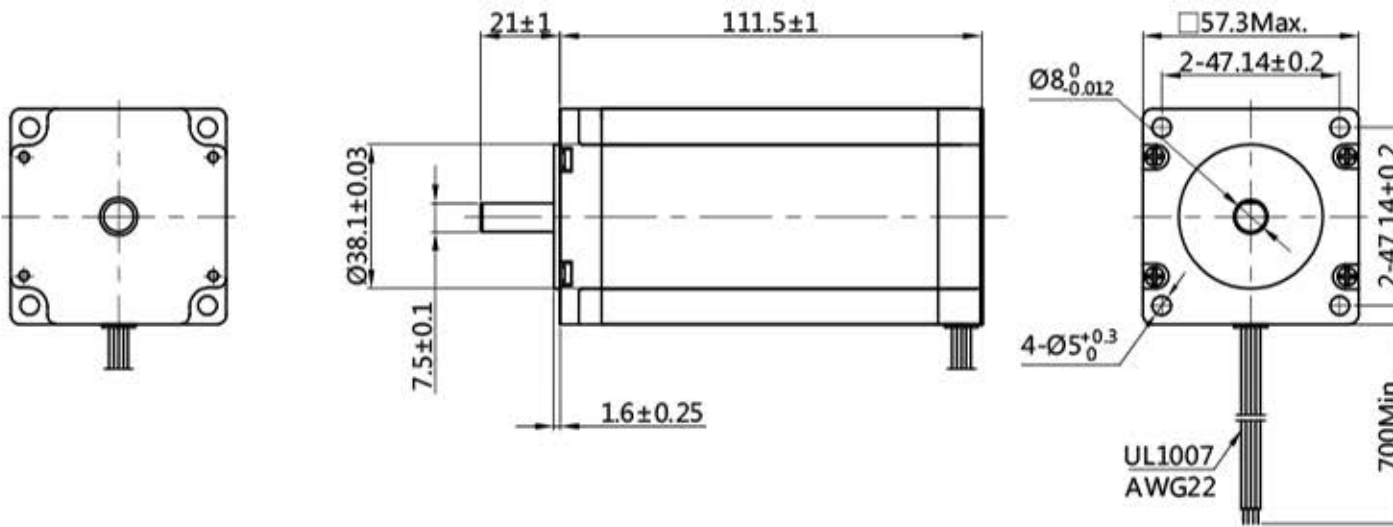

Wiring Diagram

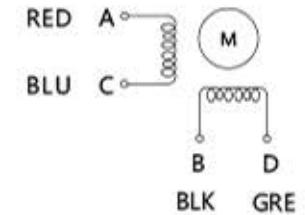

Exciting Sequence vs. Direction of Rotation

STEP	A	B	C	D	Direction
1	+	+	-	-	CCW
2	-	+	+	-	CCW
3	-	-	+	+	CW
4	+	-	-	+	CW

Clockwise view from mounting side

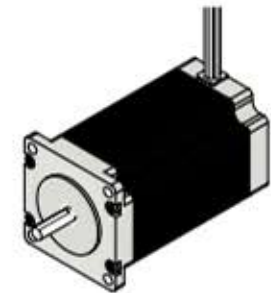

1. Number of Phase	2				
2. Step Angle	1.8° deg.				
3. Rated Voltage	6.3 V				
4. Rated Current/Phase	4.2 A (Peak Value)				
5. Phase Resistance	0.9 $\Omega \pm 0.1(20^\circ\text{C})$				
6. Phase Inductance	3.8 mH $\pm 20\%$ (1kHz 1V RMS)				
7. Holding Torque	28 Kg.cm				
8. Insulation Class	B (130°); 80K Max.				
9. Weight	1.5 kg				
Specifications		Comment			

REV.	REVISION RECORD	DATE
	DESIGN	
	STANDARD	
	TECHNOLOGY	
	CHECK	
	APPROVE	

常州倍士福机电有限公司
www.besfoc.cn

Specification

TITLE	STEPPING MOTOR				
DWG.NO.	BF57HS112-4204-03				
MATERIAL		ECN SIGN	※	SIZE	A4
REV.	A	SCALE	1:2	SHEET	1 of 1