

Dimension:  
Unit=mm

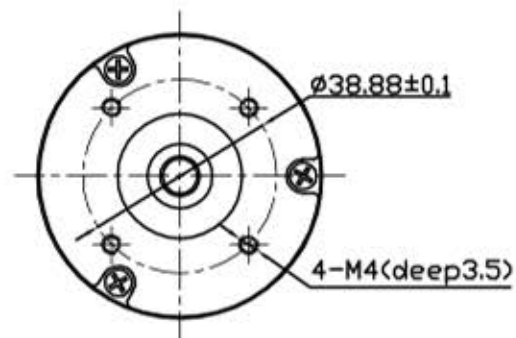
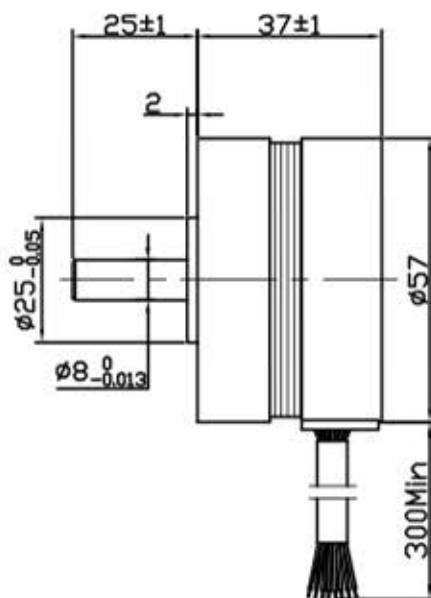

ROTATION: CCW SEE FROM LEAD END

MANUFACTURER MODEL	JK57BLS005
NUMBER OF POLES	4
PHASE TO PHASE RESISTANCE	5.1 OHMS
NOMINAL VOLTAGE	36 VDC
NO LOAD SPEED	4800±10% RPM
NO LOAD CURRENT	0.25 Amps Max.
RATED TORQUE	0.055 N-m
RATED SPEED	4000±10% RPM
OUTPUT POWER	23 W
BACK EMF CONSTANT	7.5 V/kRPM
TORQUE CONSTANT	0.072 N-m/A
INSULATION CLASS	B

ELECTRICAL CONNECTION TABLE

+5V	RED	红	UL1007 26AWG
HALL U	YEL	黄	
HALL V	GRE	绿	
HALL W	BLU	蓝	
GND	GND	黑	
PHASE U	YEL	黄	UL1007 20AWG
PHASE V	GRE	绿	
PHASE W	BLU	蓝	

Connection diagram:

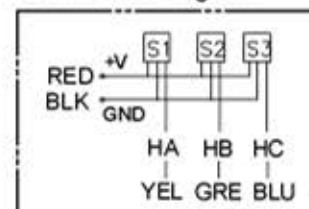

Hall sensor cable  
Note: hall sens or power supply  
voltage +5 to +20VDC

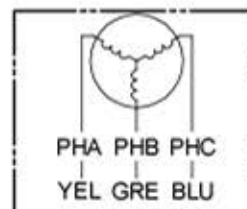

Wiring cable

REV.					Title: Specification	常州倍士福机电有限公司		
DESIGN		STD.						
CHECK					CLS.MAK	WEIGHT	SCALE	BF57BLS005
PROC.		APPR.			PAGE:	1/1		